



Barrier turnstiles

Fastlane® Glassgate 400 Plus

BARRIER TYPE

FOOTPRINT

GLASS

ARM

OPTICAL



Premium Security

Fastlane Glassgate 400 Plus now offers the extra advantage over Glassgate 400 in that larger maximum lane widths can be achieved. The GG400 Plus can offer lane widths up to 47.24" wide to allow comfortable passage of large wheelchairs. This new, large access way is now monitored by an enhanced version of the legendary Fastlane optical system capable of detecting 'sidegating', the possible collusion of two people attempting to enter side by side with just one authorization.

Advanced intelligence

Fastlane GG400 Plus now features Fastlane Connect Ethernet communication for control, configuration and diagnostics. Connection can be as simple as just connecting to your network and using Fastlane finder. Recent enhancement of the product includes the new Fastlane 40 beam-path detection engine, offering best-in-class detection and interpretation of people and objects moving between the pedestals.

Operation

Glassgate is designed to work in a normally closed mode, opening only after an access system approval. The glass barrier swings away from an authorized user. Barriers then either:

- Close quickly behind the authorized person to deter tailgaters
- Stay open for immediate additional authorized users passing in either direction

Glassgate 400 Plus barriers are difficult to push through and a locking barrier is an option. This increases security by delaying or stopping aggressive intruders. Glassgate will automatically sound a local alarm if someone enters without authorization.

- Efforts to push past the glass barrier will sound a second, louder alarm
- A secondary relay can trigger CCTV, lock doors, or control elevators

User-friendly and safe

Fastlane Speedgates feature up to 36 safety beams designed to stop the barriers from moving in the event that any of the beams are broken. The units feature a fire alarm input to allow for unimpeded emergency egress and the units can be configured to fail safe in the event of power fail.



HIGH SECURITY

Advanced technology for superior entry control

- Detects and deters tailgaters in very close proximity
- Class leading infrared detection systems



PINPOINT ACCURACY

Intelligence virtually eliminates false alarms

- Differentiates body mass from smaller objects
- Provides instant feedback of traffic flow and incidents



UNSURPASSED THROUGHPUT

Greater return on investment

- High processing speed reduces traffic build-up
- Door-like motion ensures quick user acceptance



SUPERIOR DESIGN

Refined, elegant designs accentuate lobby

- Glass barriers provide secure and welcome entry
- Barriers open flush with the pedestal, minimizing footprint



FIELD-PROVEN RELIABILITY

Uptime and long lifetime improve bottom line

- Fewer failures mean lower repair costs
- Online diagnostics and support packages

Materials

- Barriers:
 - .39" Toughened Safety Glass EN12150
 - .47" Toughened/Laminated for locking/tall options EN12150 / EN14449
- Frame and end caps: 304 stainless steel with a satin polish
- Tops: Corian® Deep Black Quartz
- Beam windows: Perspex® 962

In addition to a choice between elliptical or squared pedestal ends, a variety of premium and custom options are available to ensure Fastlane complements building aesthetics.

Visitor management

Fastlane features an optional visitor management input. When activated, unlimited access is allowed for a designated period, after which the system returns to its secure state.

Disabled access

Fastlane is compliant with ADA as well as most international standards. A wider lane using the same slim pedestals allows for wheelchair or cart access. Audio/Visual feedback is standard.

Options/Accessories

- Fastlane Technical Services
- Fastlane Floor Protector
- Fastlane Infill System
- Multiple desktop controls - IP or Analog
- FastScan™ Tenant/Visitor System
- Multiple Reader Mounting Options
- Locking Barriers
- Icon Status Display
- Sidegating

Please see Fastlane accessories data sheets for additional details.

DETAILS

Fastlane Glassgate 400 Plus dimensions

(standard, single turnstile)

Please see the Glassgate 400 Plus Drawing Pack for additional details.

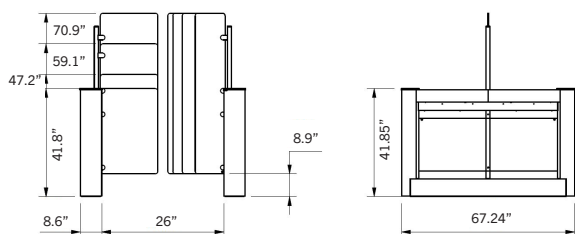

FASTLANE GLASSGATE 400 PLUS TECHNICAL SPECIFICATIONS

Pedestal dimensions (standard and ADA)

- Height: 41.85" (1,063 mm)
- Width: 8.6" (218 mm)
- Length: 67.24" (1,708 mm)

Center Glass Panel Material

- .39" (10mm) Toughened Safety Glass (Heat Soaked) EN14179 / ANSI Z97.1

Barrier glass dimensions

- Std. height: 59.1" (1,500 mm)
- Intermediate height: 47.2" (1,200 mm)
- Full height: 70.9" (1,800 mm)
- Pedestal-level height: 41.8" (1,061 mm)
- Std. width: 8.5" (216 mm)
- Wide width: 16.0" (407 mm)

Barrier breakaway force

- Friction Brakes 120N (12.2kg) nominal
- Available locking barriers 300 N (30 kg)

Lane width

- Standard lane: 26" (660 mm)
- ADA lane: 36" (914 mm)
- 43.3" (1,100 mm)
- 47.24" (1,200 mm)

Outputs to Access System

- Voltage free relay contacts rated 0.5A, 28 V DC for output to system
- Lane entered (NC)
- Lane exited Exit (NC)
- Alarm 1 (NC, opening for 1s)
- Alarm 2 (NC, opening for 1s)

Inputs from Access Control

- Require voltage-free switching (current sense 1 mA typical)
- Entry request (normally open closing for 1 second)
- Exit request (normally open closing for 1 second)
- Visitor access in & out (normally open momentary push button)
- Fire panel integration- Opto-coupled Input 12-24 V DC @ 25mA nominal

Throughput*

- 1 person / second maximum (subject to response time of access control system)

Power requirements

- Input: 115 V AC, 60 Hz or 230 V AC, 50 Hz
- Output: 24 V DC, 60 W, 1.5 A

Operating modes

- Card in/card out
- Card entry/free exit
- Free entry/card out
- Free entry/free exit

Tailgate detection distance

- 1/4" (5 mm) minimum

Reliability

- 5,000,000+ cycles*

Ethernet connection

- RJ45 TCP/IP port

Audible indicators

- Single tone sounder: card authorization and turnstile obstructions
- Multi-tone variable volume sounder: alarm condition

Optics

- Optical turnstile - pulsed multi-infrared beam array, synchronized for detection and safety
- Environmentally hardened to avoid sunlight interference

Display

- Tri-color, LED end of turnstile indicators: red, white, green

* Expected time to pass through turnstile.

* In normal use, 5,000,000 cycles of operation is expected before electromechanical subassemblies may require replacement as part of an approved preventative maintenance program.

* Fastlane logo present on left-most pedestal base. Removal available upon request.

* Due to continuous improvements, specifications are subject to change without prior notice.